

RESOLUTION NO. 22-54

**RESOLUTION EXPANDING RURAL SPECIAL
IMPROVEMENT MAINTENANCE DISTRICT #790M
(WEST KING COMM-ROADS)**

WHEREAS, pursuant to §7-12-2161(4), MCA, the Commissioners have the power of changing, by resolution, the boundaries of any maintenance district not more than once a year; and

WHEREAS the boundaries of RSID 790M have not been changed within the last year; and

WHEREAS, it has been determined that properties adjacent to the existing Rural Special Improvement District #790M boundaries are benefited properties accessing the district roads; and

WHEREAS, the benefited property status requires the expansion of boundaries for RSID 790M for the maintenance, preservation and repair roads located within the district boundaries; and

WHEREAS, the boundaries of the district will be expanded to include C16560-C16569, C16570-C16577, C16610-C16614 and C16617 in Yellowstone County, Montana, described in Exhibit B; and

WHEREAS, lots to be added to the district and boundaries of the expanded district are shown in Exhibit A (map).

NOW, THEREFORE, BE IT RESOLVED by the Board of County Commissioners of Yellowstone County, Montana, deeming the public interest or convenience require, intends to expand the following described Rural Special Improvement Maintenance District:

1. **DESCRIPTION OF IMPROVEMENTS, DESCRIPTION OF MAINTENANCE, METHOD OF ASSESSMENT AND ESTIMATED COSTS.** Assessments collected on behalf of this district shall be used for the maintenance and preservation of the roads located within the boundaries of this district. All of the costs of the district shall be assessed equally on a per lot method for existing and future lots. Assessments will be established annually by the Board of County Commissioners and are subject to adjustment due to cost fluctuations related to maintenance utilization levels and changes in material and labor costs of performing necessary maintenance.
2. **DURATION.** The district shall be deemed to be perpetual in nature unless absorbed and replaced by another district or municipality.

PASSED AND ADOPTED by the Board of County Commissioners of Yellowstone
County, Montana, this 4th day of October, 2022.

BOARD OF COUNTY COMMISSIONERS
YELLOWSTONE COUNTY, MONTANA



Donald W. Jones, Chairman

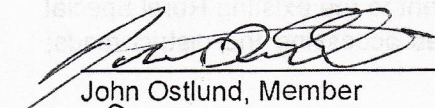

John Ostlund, Member

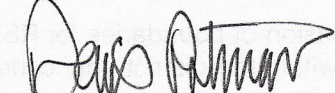

Denis Pitman, Member

(SEAL)
ATTEST:

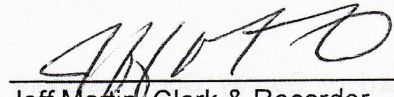

Jeff Martin, Clerk & Recorder
Yellowstone County, Montana

EXHIBIT A

D00453B

RSID 790M

New Expansion Area

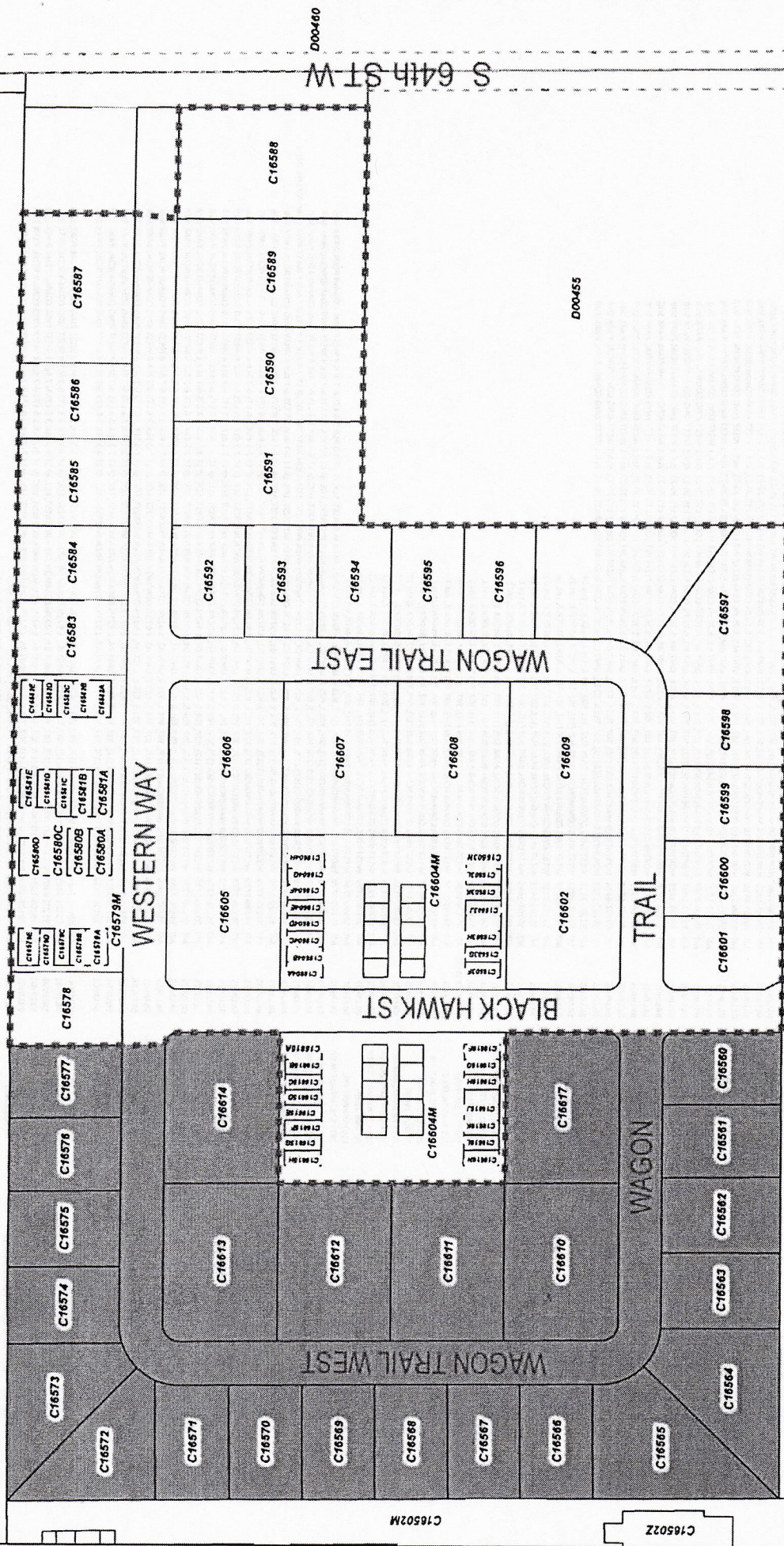

D00677A

D00628A

Exhibit B

Table with columns: Tax ID, Owner Name, Address, City, ST, Zip, Legal Description. Contains property listings for various areas including BILLYING, MELENA, and BILLINGS.

79	C166158	SAM, BRANDON & KATIE	1525 GLACIER PEAK DR	MT	59101-6394	WESTFIELD WAREHOUSES (17), 507, 701 S, R25 E, UNIT 68, 1.923% COMMON AREA INTEREST, LOC @ LT 2-3 BLK 3 & LTS 6-7 BLK 4 WEST KING COMMERCIAL PARK SUB
80	C166159	C-STONES PROPERTIES LLC	PO BOX 80391	MT	59108-0391	WESTFIELD WAREHOUSES (17), 507, 701 S, R25 E, UNIT 61, 1.923% COMMON AREA INTEREST, LOC @ LT 2-3 BLK 3 & LTS 6-7 BLK 4 WEST KING COMMERCIAL PARK SUB
81	C166160	DISCREET SOLUTIONS INC/CONTINENCE SUPPLIES LLC	710 BLACK HAWK ST UNIT F2	MT	59106	WESTFIELD WAREHOUSES (17), 507, 701 S, R25 E, UNIT 62, 1.923% COMMON AREA INTEREST, LOC @ LT 2-3 BLK 3 & LTS 6-7 BLK 4 WEST KING COMMERCIAL PARK SUB
82	C166161	GAMBLER INVESTMENTS LLC	711 SHILOH RD	MT	59106-1714	WESTFIELD WAREHOUSES (17), 507, 701 S, R25 E, UNIT 63, 1.923% COMMON AREA INTEREST, LOC @ LT 2-3 BLK 3 & LTS 6-7 BLK 4 WEST KING COMMERCIAL PARK SUB
83	C166162	RN LIVING TRUST & S	720 HILGROESS PL	MT	59106-1714	WESTFIELD WAREHOUSES (17), 507, 701 S, R25 E, UNIT 64, 1.923% COMMON AREA INTEREST, LOC @ LT 2-3 BLK 3 & LTS 6-7 BLK 4 WEST KING COMMERCIAL PARK SUB
84	C166163	OLESEN, MARK T & KIMBERLEY A	448 GRIFFIN AVE	MT	59105-3030	WESTFIELD WAREHOUSES (17), 507, 701 S, R25 E, UNIT 65, 1.923% COMMON AREA INTEREST, LOC @ LT 2-3 BLK 3 & LTS 6-7 BLK 4 WEST KING COMMERCIAL PARK SUB
85	C166164	KM STORAGE LLC	1001 GOLD CREEK TRL	MT	59105-1732	WESTFIELD WAREHOUSES (17), 507, 701 S, R25 E, UNIT 66, 1.923% COMMON AREA INTEREST, LOC @ LT 2-3 BLK 3 & LTS 6-7 BLK 4 WEST KING COMMERCIAL PARK SUB
86	C166165	LCAR INVESTMENTS LLC	821 N 27TH ST # 117	MT	59001-5635	WESTFIELD WAREHOUSES (17), 507, 701 S, R25 E, UNIT 67, 1.923% COMMON AREA INTEREST, LOC @ LT 2-3 BLK 3 & LTS 6-7 BLK 4 WEST KING COMMERCIAL PARK SUB
87	C166166	SHOP AT WESTERN WAY LLC	3116 WAGON TRL	MT	59101-1121	WESTFIELD WAREHOUSES (17), 507, 701 S, R25 E, UNIT 68, 1.923% COMMON AREA INTEREST, LOC @ LT 2-3 BLK 3 & LTS 6-7 BLK 4 WEST KING COMMERCIAL PARK SUB
88	C166167	MINGEE, GEORGE	6513 WAGON TRL	MT	59102-3738	WESTFIELD WAREHOUSES (17), 507, 701 S, R25 E, UNIT 69, 1.923% COMMON AREA INTEREST, LOC @ LT 2-3 BLK 3 & LTS 6-7 BLK 4 WEST KING COMMERCIAL PARK SUB
89	C166168	ANDERSON, ERIC F & DALE S	2236 ALAMO DR	MT	59106-9895	WESTFIELD WAREHOUSES (17), 507, 701 S, R25 E, UNIT 70, 1.923% COMMON AREA INTEREST, LOC @ LT 2-3 BLK 3 & LTS 6-7 BLK 4 WEST KING COMMERCIAL PARK SUB
90	C166169	DIRECT RENT LLC	PO BOX 10237	MT	59102-3737	WESTFIELD WAREHOUSES (17), 507, 701 S, R25 E, UNIT 71, 1.923% COMMON AREA INTEREST, LOC @ LT 2-3 BLK 3 & LTS 6-7 BLK 4 WEST KING COMMERCIAL PARK SUB
91	C166170	DICKVEY, JAY	3945 WOODCREEK DR	MT	59102-3737	WESTFIELD WAREHOUSES (17), 507, 701 S, R25 E, UNIT 72, 1.923% COMMON AREA INTEREST, LOC @ LT 2-3 BLK 3 & LTS 6-7 BLK 4 WEST KING COMMERCIAL PARK SUB
92	C166171	DICKVEY, JAY	922 WESTGATE DR	MT	59102-3737	WESTFIELD WAREHOUSES (17), 507, 701 S, R25 E, UNIT 73, 1.923% COMMON AREA INTEREST, LOC @ LT 2-3 BLK 3 & LTS 6-7 BLK 4 WEST KING COMMERCIAL PARK SUB
93	C166172	DICKVEY, JAY				
94	C166173	HOFFMAN, KERRY P & CAROL J				
95	C166174	WALTON & SON LLC				
96	C166175	BRIANNE CARLSON PROPERTIES LLC				
97	C166176	LIP RIPPIN VENTURE LLC				

Proposed expansion to include parcels below:

1	C16560	WEST KING COMMERCIAL PARK LP	PO BOX 21495	MT	59104-1495	WEST KING COMMERCIAL PARK SUB (11), 507, 701 S, R25 E, BLOCK 1, Lot 1
2	C16561	WEST KING COMMERCIAL PARK LP	PO BOX 21495	MT	59104-1495	WEST KING COMMERCIAL PARK SUB (11), 507, 701 S, R25 E, BLOCK 1, Lot 2
3	C16562	WEST KING COMMERCIAL PARK LP	PO BOX 21495	MT	59104-1495	WEST KING COMMERCIAL PARK SUB (11), 507, 701 S, R25 E, BLOCK 1, Lot 3
4	C16563	WEST KING COMMERCIAL PARK LP	PO BOX 21495	MT	59104-1495	WEST KING COMMERCIAL PARK SUB (11), 507, 701 S, R25 E, BLOCK 1, Lot 4
5	C16564	WEST KING COMMERCIAL PARK LP	PO BOX 21495	MT	59104-1495	WEST KING COMMERCIAL PARK SUB (11), 507, 701 S, R25 E, BLOCK 1, Lot 5
6	C16565	WEST KING COMMERCIAL PARK LP	PO BOX 21495	MT	59104-1495	WEST KING COMMERCIAL PARK SUB (11), 507, 701 S, R25 E, BLOCK 1, Lot 6
7	C16566	NIGHTYFINE LLC	1001 S MAIN ST	MT	59001-5635	WEST KING COMMERCIAL PARK SUB (11), 507, 701 S, R25 E, BLOCK 1, Lot 7
8	C16567	NIGHTYFINE LLC	1001 S MAIN ST	MT	59001-5635	WEST KING COMMERCIAL PARK SUB (11), 507, 701 S, R25 E, BLOCK 1, Lot 8
9	C16568	EGGART ENTERPRISES LLC	7701 OHWEST LN	MT	59106-2866	WEST KING COMMERCIAL PARK SUB (11), 507, 701 S, R25 E, BLOCK 1, Lot 9
10	C16569	RPM CONTRACTING LLC	6340 RIDGE STONE DR N	MT	59106-9717	WEST KING COMMERCIAL PARK SUB (11), 507, 701 S, R25 E, BLOCK 1, Lot 10
11	C16570	WEST KING COMMERCIAL PARK LP	PO BOX 21495	MT	59104-1495	WEST KING COMMERCIAL PARK SUB (11), 507, 701 S, R25 E, BLOCK 1, Lot 11
12	C16571	WEST KING COMMERCIAL PARK LP	PO BOX 21495	MT	59104-1495	WEST KING COMMERCIAL PARK SUB (11), 507, 701 S, R25 E, BLOCK 1, Lot 12
13	C16572	WEST KING COMMERCIAL PARK LP	PO BOX 21495	MT	59104-1495	WEST KING COMMERCIAL PARK SUB (11), 507, 701 S, R25 E, BLOCK 1, Lot 13
14	C16573	WEST KING COMMERCIAL PARK LP	PO BOX 21495	MT	59104-1495	WEST KING COMMERCIAL PARK SUB (11), 507, 701 S, R25 E, BLOCK 1, Lot 14
15	C16574	BRIANNE CARLSON PROPERTIES LLC	3945 WOODCREEK DR	MT	59106-9895	WEST KING COMMERCIAL PARK SUB (11), 507, 701 S, R25 E, BLOCK 1, Lot 15
16	C16575	BRIANNE CARLSON PROPERTIES LLC	3945 WOODCREEK DR	MT	59106-9895	WEST KING COMMERCIAL PARK SUB (11), 507, 701 S, R25 E, BLOCK 1, Lot 16
17	C16576	HARRIS CAPITAL, LLC	PO BOX 81010	MT	59104-1495	WEST KING COMMERCIAL PARK SUB (11), 507, 701 S, R25 E, BLOCK 1, Lot 17
18	C16577	165 PROPERTIES, INC	PO BOX 31292	MT	59102-1283	WEST KING COMMERCIAL PARK SUB (11), 507, 701 S, R25 E, BLOCK 1, Lot 18
19	C16578	WEST KING COMMERCIAL PARK LP	PO BOX 21495	MT	59104-1495	WEST KING COMMERCIAL PARK SUB (11), 507, 701 S, R25 E, BLOCK 1, Lot 19
20	C16579	WEST KING COMMERCIAL PARK LP	PO BOX 21495	MT	59104-1495	WEST KING COMMERCIAL PARK SUB (11), 507, 701 S, R25 E, BLOCK 1, Lot 20
21	C16580	WEST KING COMMERCIAL PARK LP	PO BOX 21495	MT	59104-1495	WEST KING COMMERCIAL PARK SUB (11), 507, 701 S, R25 E, BLOCK 1, Lot 21
22	C16581	WEST KING COMMERCIAL PARK LP	PO BOX 21495	MT	59104-1495	WEST KING COMMERCIAL PARK SUB (11), 507, 701 S, R25 E, BLOCK 1, Lot 22
23	C16582	WEST KING COMMERCIAL PARK LP	PO BOX 21495	MT	59104-1495	WEST KING COMMERCIAL PARK SUB (11), 507, 701 S, R25 E, BLOCK 1, Lot 23
24	C16583	WEST KING COMMERCIAL PARK LP	PO BOX 21495	MT	59104-1495	WEST KING COMMERCIAL PARK SUB (11), 507, 701 S, R25 E, BLOCK 1, Lot 24

(OLD #0454)

(OLD #0454)